

DRAWING_1

MS300 FRAME E

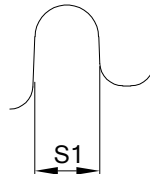
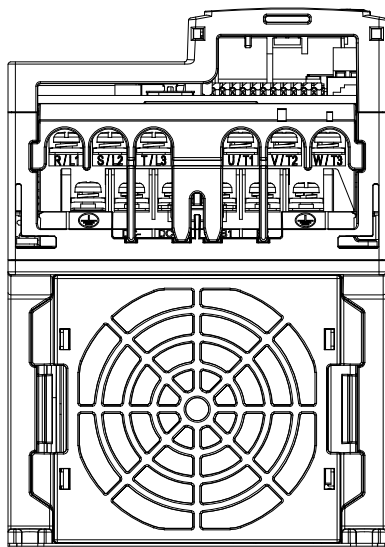
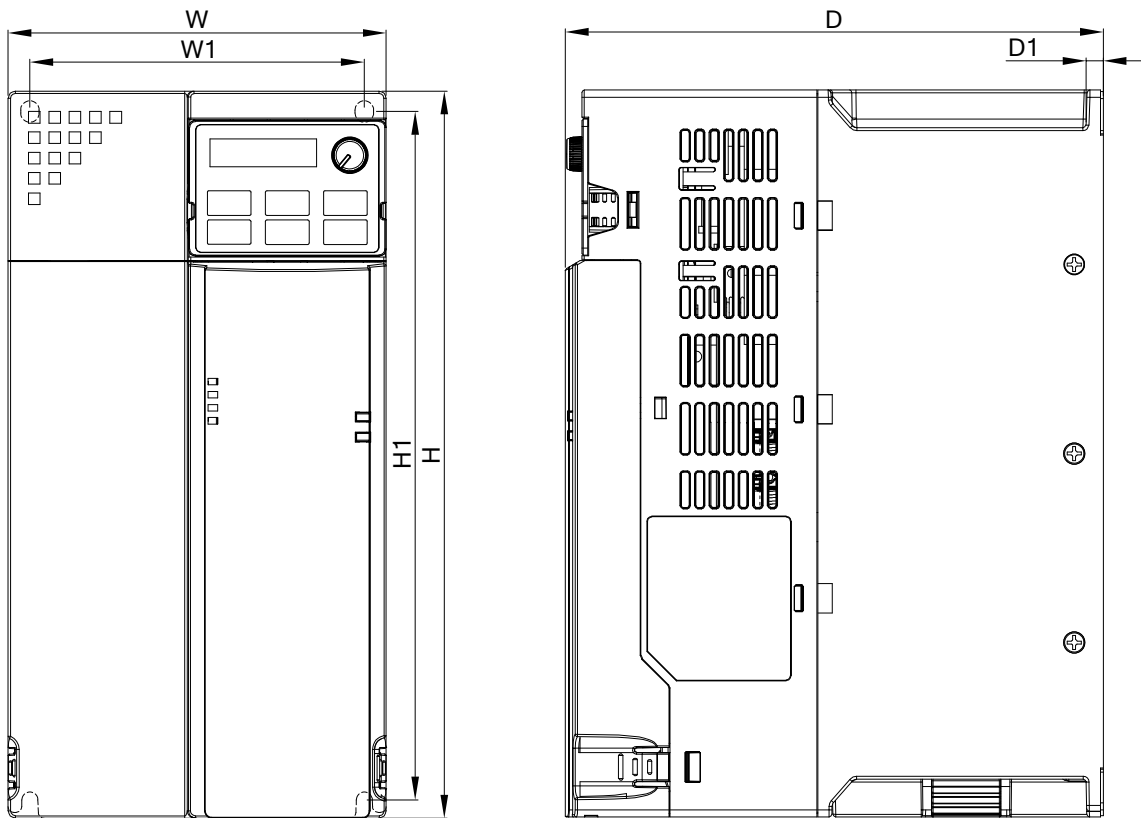

Mounting Hole

DIMENSION :

UNIT : mm[inch]

FRAME	W	W1	H	H1	D	D1	S1
E1	130.0[5.12]	115.0[4.53]	250.0[9.84]	236.8[9.32]	185.0[7.83]	6.0[0.24]	5.5[0.22]
E2	130.0[5.12]	115.0[4.53]	250.0[9.84]	236.8[9.32]	219.0[8.62]	6.0[0.24]	5.5[0.22]



台達電子工業股份有限公司

DELTA ELECTRONICS, INC.

THESE DRAWINGS AND SPECIFICATIONS ARE THE PROPERTY OF DELTA ELECTRONICS, INC. AND SHALL NOT BE REPRODUCED OR USED AS THE BASIS FOR THE MANUFACTURE OR SELL OF APPARATUSES OR DEVICES WITHOUT PERMISSION.

DOCUMENT NAME

VFD-MS300-E-PD

STANDARD

1.MODEL:

FRAME_E1:

VFD33AMS23ANSAA
 VFD33AMS23ENSAA
 VFD49AMS23ANSAA
 VFD49AMS23ENSAA
 VFD25AMS43ANSAA
 VFD25AMS43ENSAA
 VFD32AMS43ANSAA
 VFD32AMS43ENSAA
 VFD33AMS23ANSHA
 VFD33AMS23ENSHA
 VFD49AMS23ANSHA
 VFD49AMS23ENSHA
 VFD25AMS43ANSHA
 VFD25AMS43ENSHA
 VFD32AMS43ANSHA
 VFD32AMS43ENSHA

FRAME_E2:

VFD25AMS43AFSHA
 VFD32AMS43AFSHA

07	Add. Models: ANSAJ	2019/06/12
06	Add. Drawing_2a For GS20 Series	2019/04/10
00	FIRST ISSUE	2014/12/04
REV.	DESCRIPTION	DATE
DRAWN	Prandtl.Tsai	DESIGN HONGDA.LU